

KW

COMPUTER 12897A1

FIRST SHEET SHEET 1 OF 19 SHEETS

STRATA PLAN OF LOT 1, SECTION 27, BLOCK 5 NORTH, STRATA PLAN  
RANGE 1 WEST, N.W.D., PLAN LMP7179 LMS 1660

SCALE-1:500  
0 5 10 20  
ALL DISTANCES ARE IN METRES



THIS PLAN LIES WITHIN THE GREATER VANCOUVER REGIONAL DISTRICT  
CITY OF SURREY  
CIVIC ADDRESS  
S.L.'S 1 TO 28 - 10340 156th ST., SURREY, B.C.  
S.L.'S 29 TO 72 - 10320 156th ST., SURREY, B.C.

DEPOSITED AND REGISTERED IN THE LAND TITLE OFFICE AT NEW WESTMINSTER, B.C. THIS 23<sup>rd</sup> DAY OF OCT 1994.  
*[Signature]*  
ASSISTANT DEPUTY REGISTRAR

BH380230

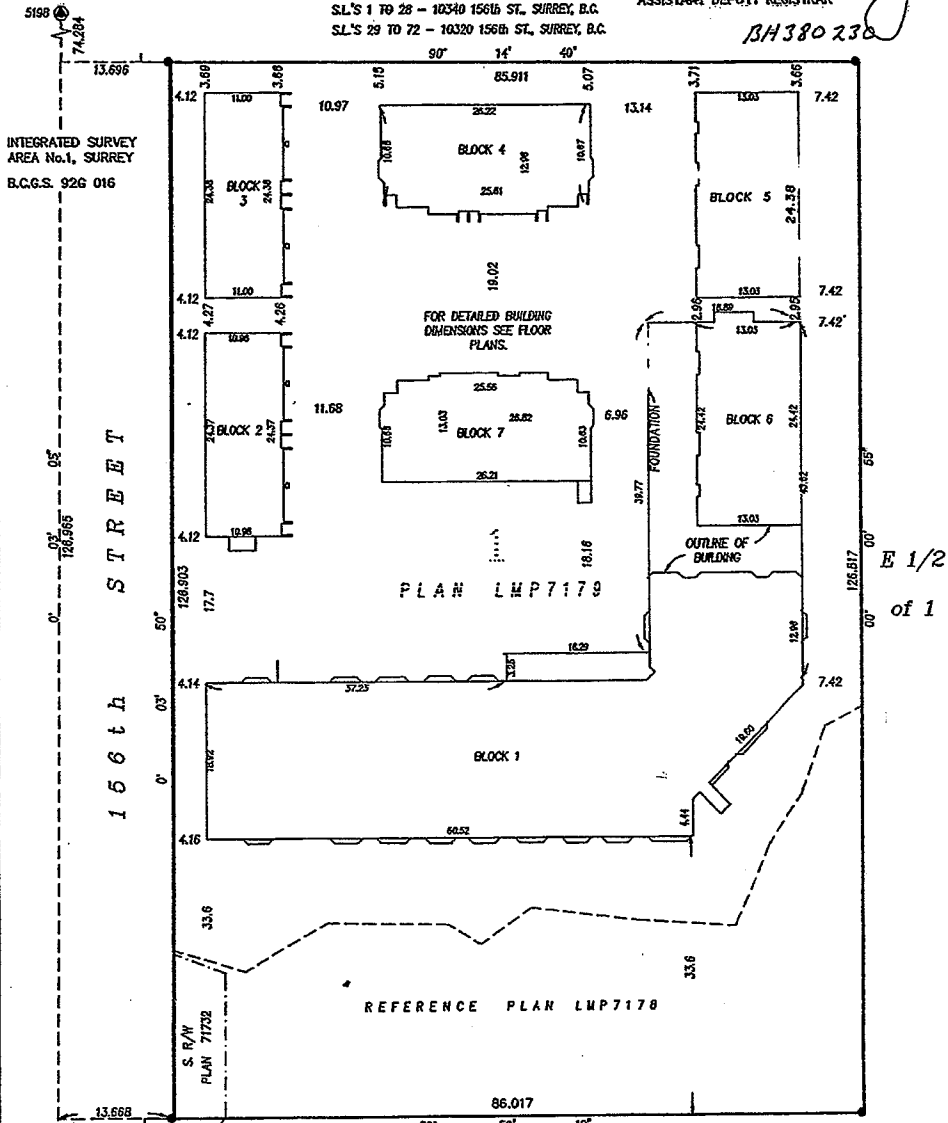

INTEGRATED SURVEY AREA No.1, SURREY B.C.G.S. 926 016

156th STREET

E 1/2 of 1

- 79H-0011
- LEGEND
- L.C.P. INDICATES LIMITED COMMON PROPERTY
  - Sq. m. . . . . SQUARE METRES
  - S.L. . . . . STRATA LOT
  - PT. . . . . PART
  - CS. . . . . CRAWLSPACE
  - ST. . . . . STORAGE
  - OTB . . . . . OPEN TO BELOW
  - © . . . . . COMMON PROPERTY
  - ST. . . . . STAIRS
  - ELEC. . . . . ELEVATOR
  - ELEC. . . . . ELECTRICAL ROOM/CLOSET
  - V. . . . . VENT
  - . . . . . OLD IRON POST FOUND
  - . . . . . IRON POST SET
  - . . . . . OLD LEAD PLUG FOUND
  - . . . . . LEAD PLUG SET
  - . . . . . OLD CONTROL MONUMENT FOUND

NOTE: ALL STRATA LOT ANGLES ARE 45 OR 90 DEGREES UNLESS OTHERWISE NOTED.

GRID BEARINGS ARE DERIVED FROM OLD CONTROL MONUMENTS 79H-0011 AND 5196.

THIS PLAN SHOWS GROUND LEVEL MEASURED DISTANCES. PRIOR TO COMPUTATION OF UTM COORDINATES MULTIPLY BY THE COMBINED FACTOR 0.99559315

THE ADDRESS FOR SERVICE OF DOCUMENTS ON THE STRATA CORPORATION IS: THE OWNER'S STRATA PLAN LMS 1660  
10320 156th STREET,  
SURREY, B.C.

I, G.A. ROWBOTHAM, OF THE CITY OF WHITE ROCK BRITISH COLUMBIA LAND SURVEYOR, HEREBY CERTIFY THAT THE BUILDING ERRECTED ON THE PARCEL DESCRIBED ABOVE IS WHOLLY WITHIN THE EXTERNAL BOUNDARIES OF THAT PARCEL.

*G.A. Rowbotham*  
B. C. L. S.

DATED AT WHITE ROCK, B.C. THIS 28<sup>th</sup> DAY OF SEPTEMBER, 1994.

STRATA PLAN LMS 1660

NEW DEVELOPMENT CERTIFICATE

I, G.A. ROWBOTHAM, A BRITISH COLUMBIA LAND SURVEYOR, HEREBY CERTIFY THAT THE BUILDINGS SHOWN IN THIS STRATA PLAN HAVE NOT, AS OF THE 8<sup>th</sup> DAY OF SEPT., 1994, BEEN PREVIOUSLY OCCUPIED. DATED AT WHITE ROCK, BRITISH COLUMBIA, THIS 28<sup>th</sup> DAY OF SEPT., 1994.

G.A. Rowbotham  
B. C. L. S.

SIGNATURES

STATUTORY DECLARATION

WE THE UNDERSIGNED DO SOLEMNLY DECLARE THAT  
(1) WE THE UNDERSIGNED ARE THE OWNER DEVELOPER  
(2) THE STRATA PLAN IS ENTIRELY FOR RESIDENTIAL USE  
WE MAKE THIS SOLEMN DECLARATION CONSCIENTIOUSLY BELIEVING IT TO BE TRUE AND KNOWING THAT IT IS OF THE SAME FORCE AND EFFECT AS IF MADE UNDER OATH.

[Signature]  
GEORGE MUELLER

DECLARED BEFORE ME THIS 30 DAY OF September, 1994.

A COMMISSIONER FOR TAKING AFFIDAVITS WITHIN THE PROVINCE OF BRITISH COLUMBIA.  
[Signature]

ACCEPTED AS TO FORMS 1, 2 AND 3

THIS 20 DAY OF OCTOBER, 1994.

[Signature]  
SUPERINTENDENT OF REAL ESTATE

OWNER : PIONEER DESIGNS (1980) CORPORATION

[Signature]  
AUTHORIZED SIGNATORY  
GEORGE MUELLER

AUTHORIZED SIGNATORY

WITNESS : [Signature]

ADDRESS AND OCCUPATION OF WITNESS :  
GARY DAVAN, Lawyer  
1628 West 7th Avenue  
Vancouver B.C. V6T 1S5

MORTGAGEE : ROYNAT INC.

Wayne Declercq  
AUTHORIZED SIGNATORY WAYNE DECLERCK  
Robert W. Lams  
AUTHORIZED SIGNATORY ROBERT W. LAMS

WITNESS :  
Alicia Pipher  
ALICIA PIPHER

ADDRESS AND OCCUPATION OF WITNESS :  
#205-60 Richmond St.  
New Westminster, BC  
V3L 5A7 SECRETARY

14-M3-326

G.A.R.  
DATED THIS 28<sup>th</sup> DAY OF SEPT., 1994. B.C.L.S.

### CONDOMINIUM ACT

LOT NUMBER	SHEET NUMBER	FORM 1	FORM 2	FORM 3
		SCHEDULE OF UNIT ENTITLEMENT	SCHEDULE OF INTEREST UPON DESTRUCTION	SCHEDULE OF VOTING RIGHTS
1	9	1602	1967	
2	9	1611	1937	
3	9	1613	1937	
4	9	1601	1967	
5	10	1609	1967	
6	10	1611	1937	
7	10	1611	1937	
8	10	1605	1967	
9	11	1562	1945	
10	11	1622	1879	
11	11	1619	1879	
12	11	1616	1879	
13	11	1558	1945	
14	12	1618	1995	
15	12	1621	1955	
16	12	1620	1955	
17	12	1623	1955	
18	12	1610	1995	
19	13	1600	1955	
20	13	1620	1925	
21	13	1619	1925	
22	13	1620	1925	
23	13	1606	1955	
24	14	1551	1977	
25	14	1620	1910	
26	14	1620	1910	
27	14	1622	1910	
28	14	1551	1977	
29	6	1018	1409	
30	6	1006	1489	
31	6	1012	1489	
32	6	846	1289	
33	6	770	1232	
34	6	728	1217	
35	6	773	1232	
36	6	729	1217	
37	6	774	1232	
38	6	981	1469	
39	6	1011	1466	
40	6	1011	1456	
41	6	993	1429	
42	6	774	1195	
43	7	1017	1439	
44	7	1030	1536	
45	7	1036	1536	
46	7	847	1319	
47	7	769	1262	
48	7	729	1247	
49	7	776	1262	
50	7	729	1247	
51	7	777	1262	
52	7	985	1499	
53	7	1038	1516	
54	7	1038	1496	
55	7	997	1459	
56	7	778	1225	
57	7	952	1403	
58	8	1017	1469	
59	8	1036	1566	
60	8	1040	1566	
61	8	847	1349	
62	8	769	1292	
63	8	729	1277	
64	8	775	1292	
65	8	729	1277	
66	8	774	1292	
67	8	981	1529	
68	8	1039	1548	
69	8	1043	1526	
70	8	987	1499	
71	8	777	1255	
72	8	950	1433	
AGGREGATE		84,390	115,074	

STRATA PLAN LMS 1/2/00

DATED THIS 28<sup>TH</sup> DAY OF SEPT., 1994.  
G.A.R.  
 B.C.L.S.

# STRATA PLAN LMS 1660

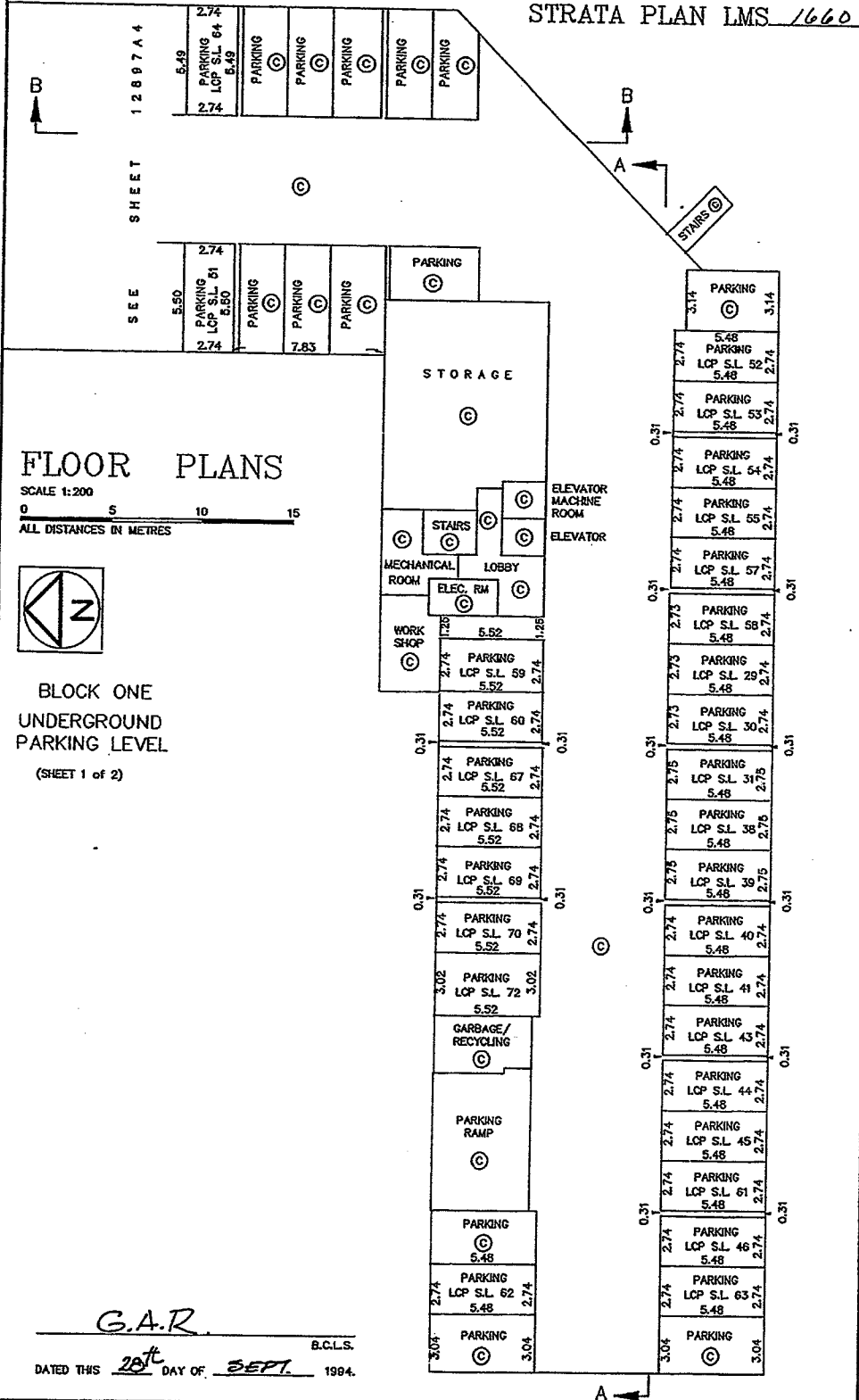

## FLOOR PLANS

SCALE 1:200  
0 5 10 15  
ALL DISTANCES IN METRES

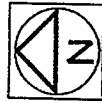

BLOCK ONE  
UNDERGROUND  
PARKING LEVEL  
(SHEET 1 of 2)

G.A.R.

B.C.L.S.

DATED THIS 28<sup>th</sup> DAY OF SEPT. 1994.

# FLOOR PLANS

# STRATA PLAN LMS 1660

SCALE 1:200



## BLOCK ONE UNDERGROUND PARKING LEVEL

(SHEET 2 of 2)

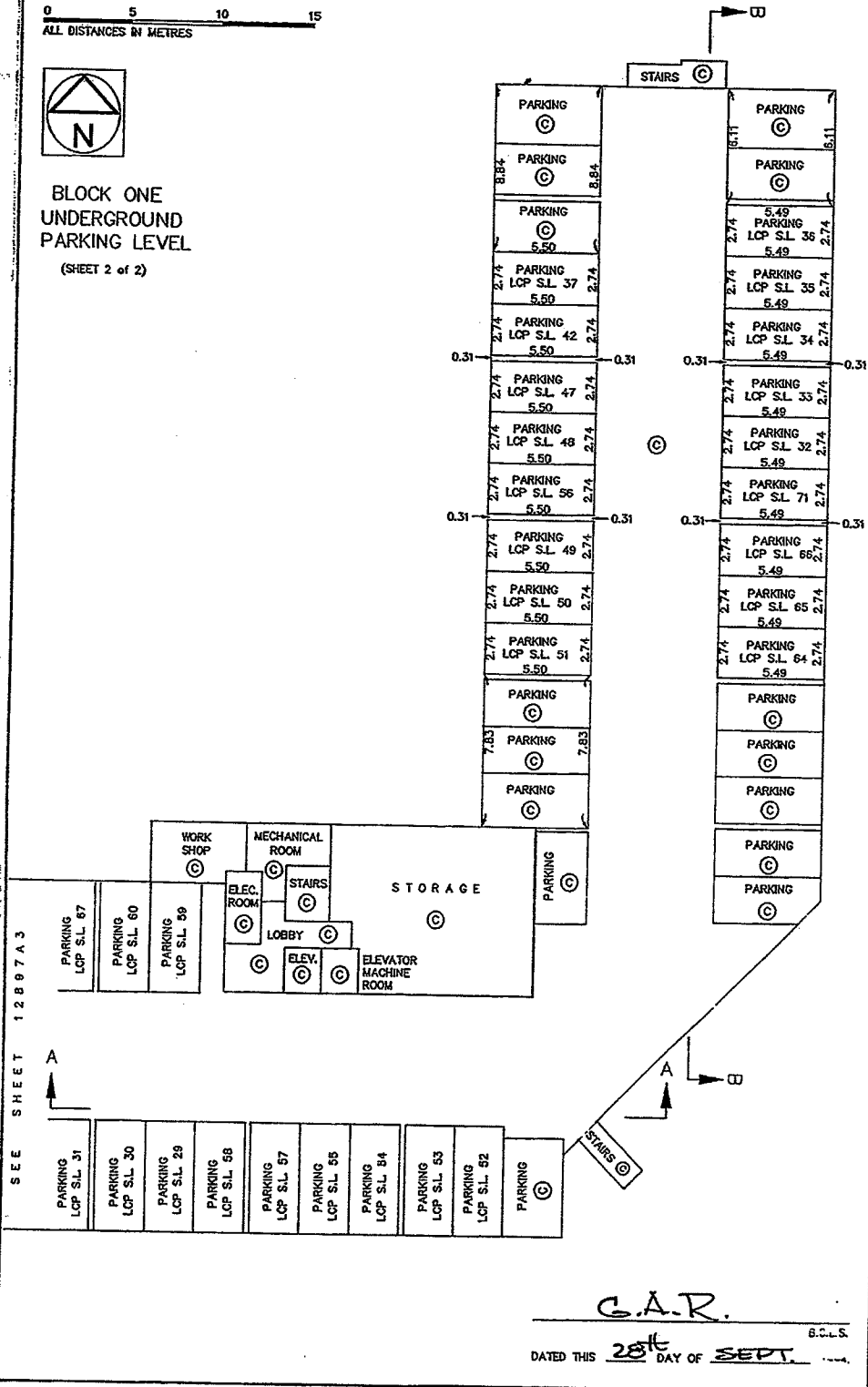

G.A.R.

B.C.L.S.

DATED THIS 28th DAY OF SEPT.

# FLOOR PLANS

# STRATA PLAN LMS 1660

SCALE 1:200  
0 5 10  
ALL DISTANCES IN METRES



BLOCK ONE  
LEVEL ONE

G.A.R.  
DATED THIS 20<sup>th</sup> DAY OF SEPT. 1994

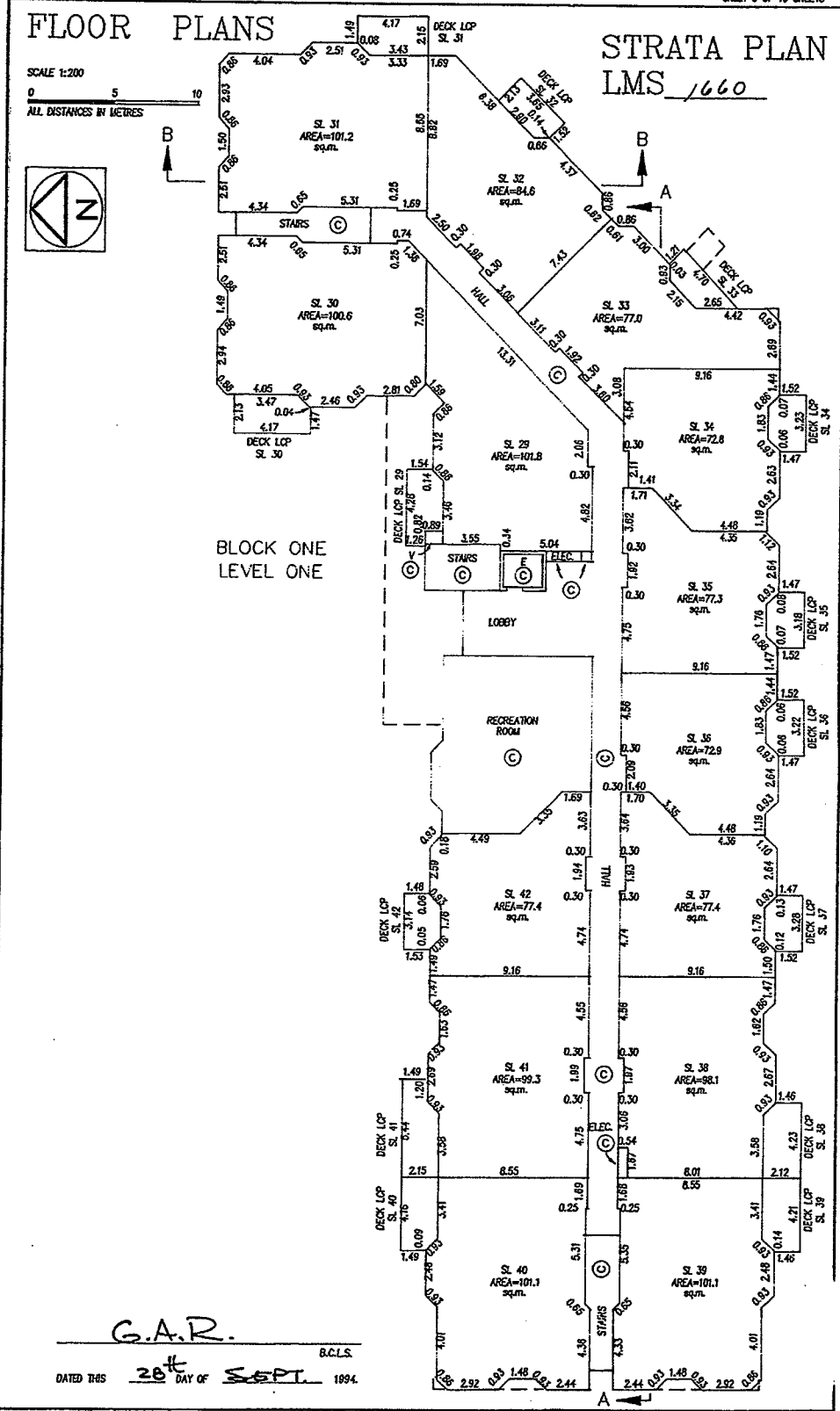

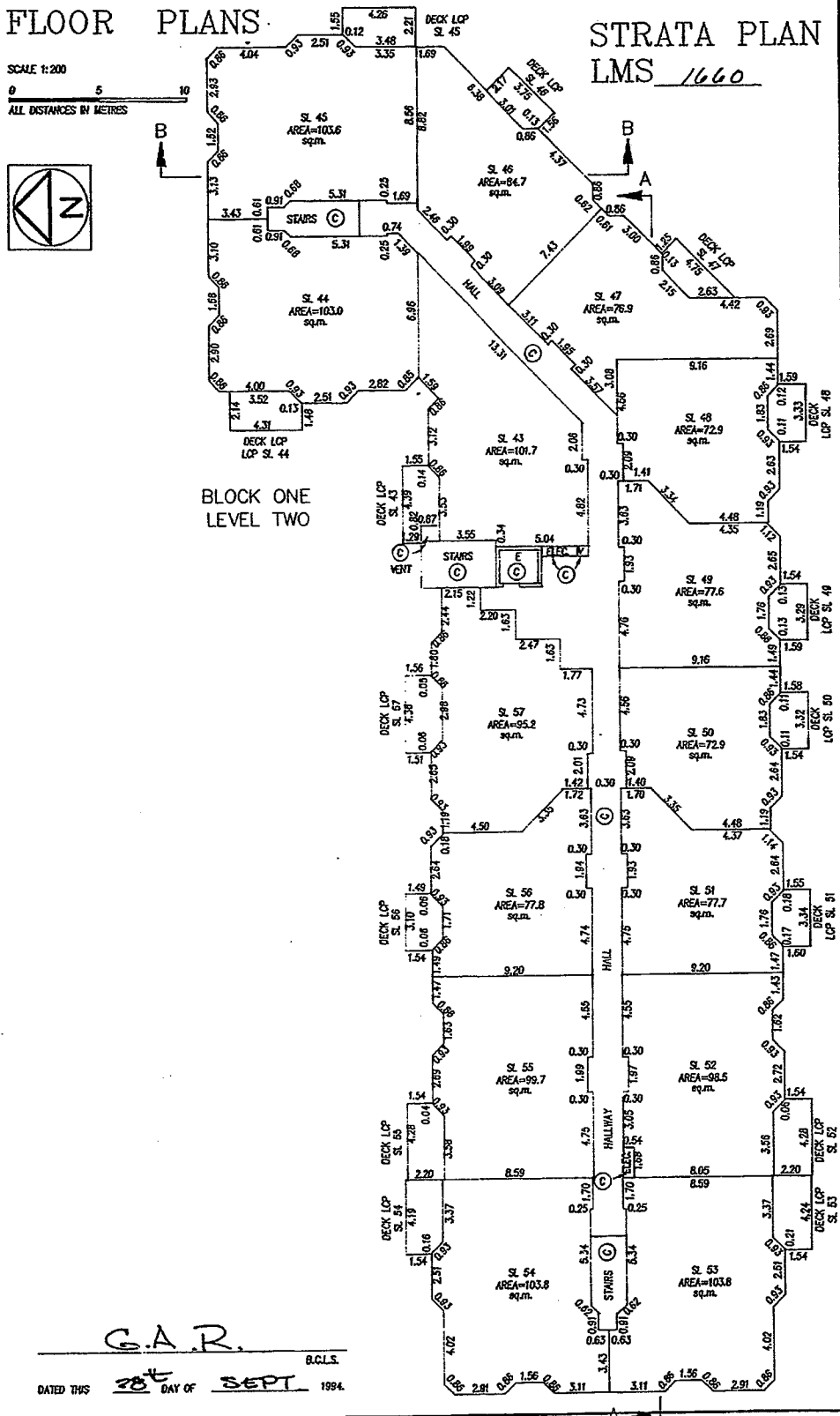

# FLOOR PLANS

# STRATA PLAN LMS 1660

SCALE: 1:200

ALL DIMENSIONS IN METERS



BLOCK ONE  
LEVEL THREE

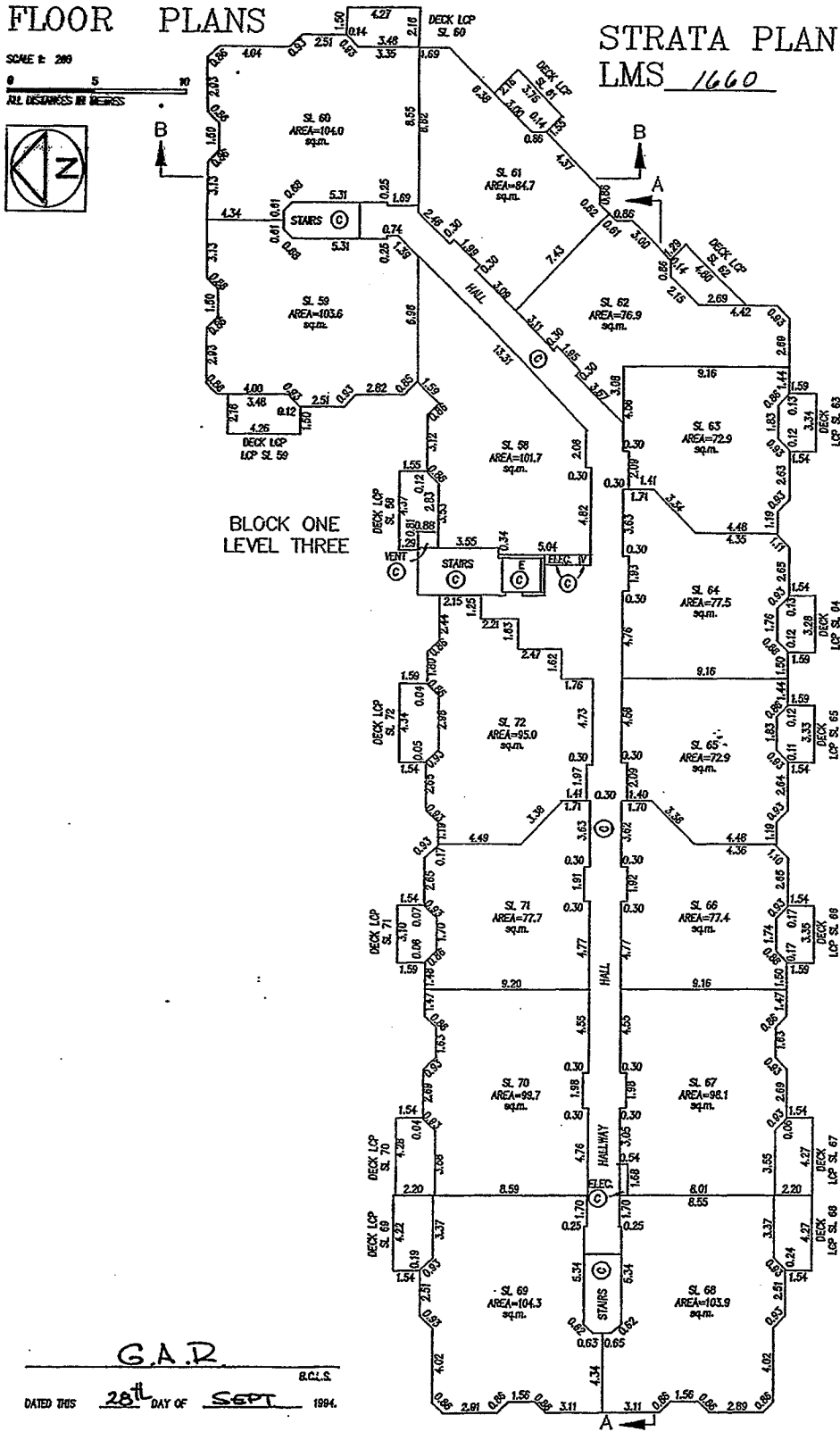

G.A.R.

R.C.L.S.

DATED THIS 28<sup>th</sup> DAY OF SEPT 1994.



# FLOOR PLANS

# STRATA PLAN LMS 1660

SCALE 1:200

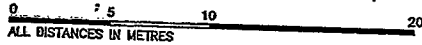

## BLOCK 2

### BASEMENT FLOOR

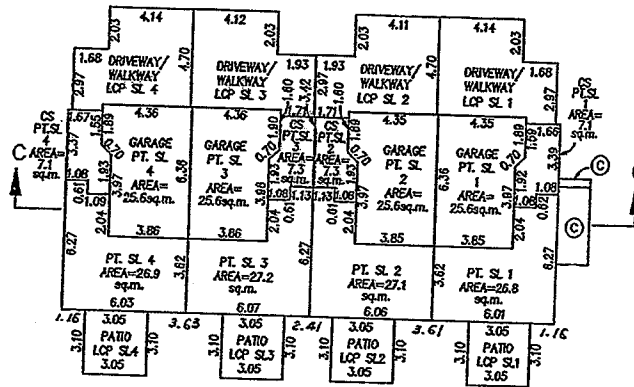

### MAIN FLOOR

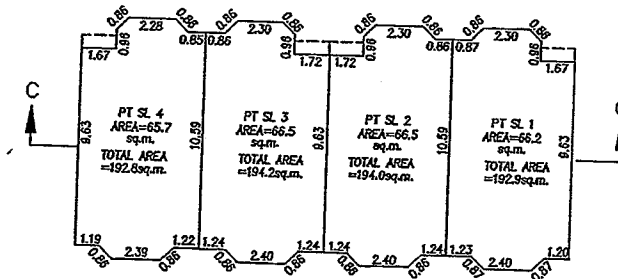

### UPPER FLOOR

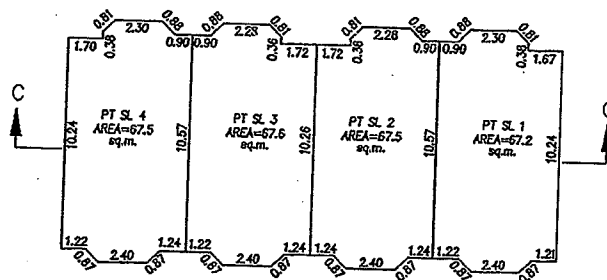

G.A.R.  
B.C.L.S.  
DATED THIS 28<sup>th</sup> DAY OF SEPT 1994.

12897A9

SHEET 10 OF 19 SHEETS

# FLOOR PLANS

# STRATA PLAN LMS 1660

SCALE 1:200



ALL DISTANCES IN METRES



## BLOCK 3

### BASEMENT FLOOR

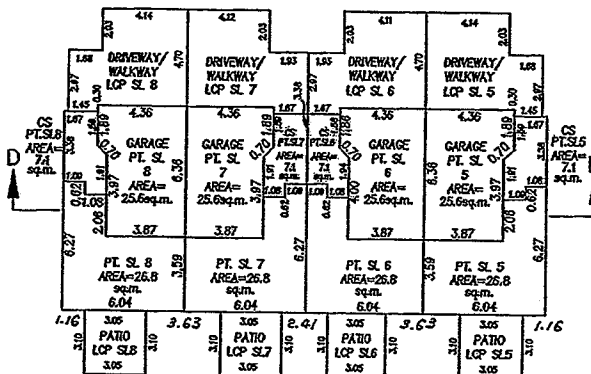

### MAIN FLOOR

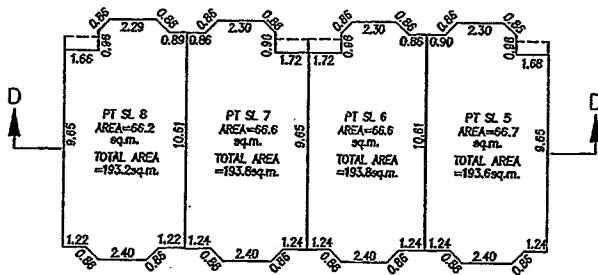

### UPPER FLOOR

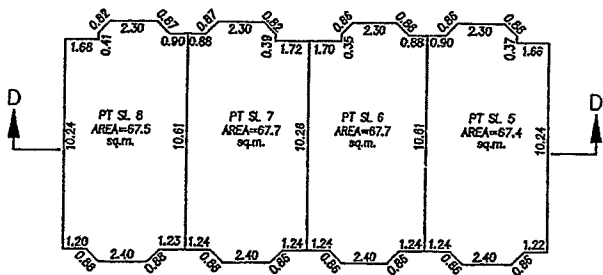

G.A.R.

B.C.L.S.

DATED THIS 28<sup>th</sup> DAY OF SEPT. 1994.

# FLOOR PLANS

# STRATA PLAN LMS 1660

SCALE 1:200

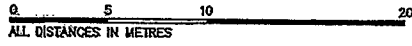

## BLOCK 4

## GROUND FLOOR

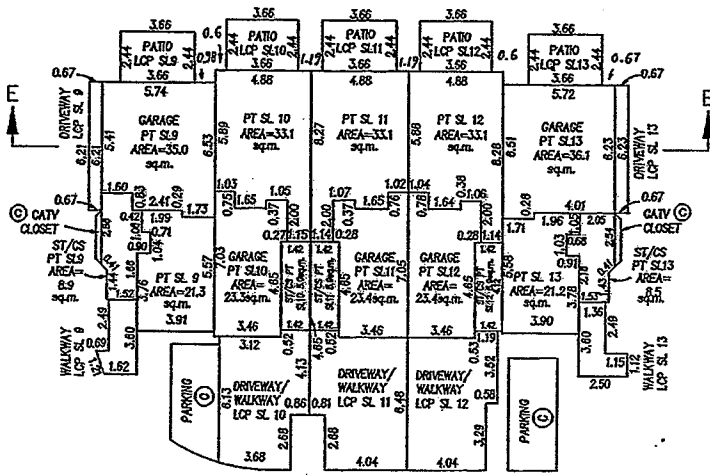

## MAIN FLOOR

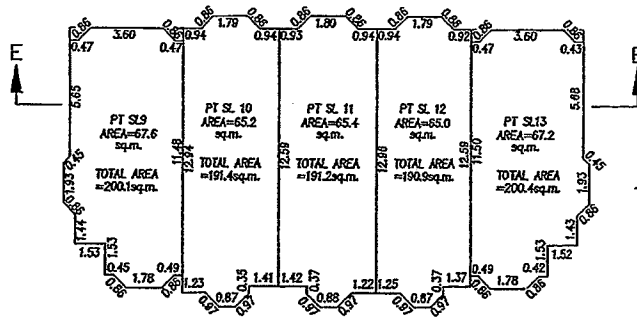

## UPPER FLOOR

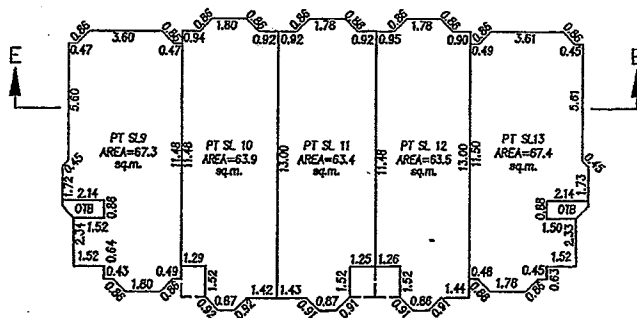

G.A.R.

B.C.L.S.

DATED THIS 28<sup>th</sup> DAY OF SEPT. 1994.

# FLOOR PLANS

# STRATA PLAN LMS 1660

SCALE 1: 200

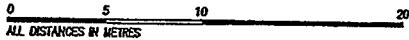

ALL DISTANCES IN METRES

## BLOCK 5

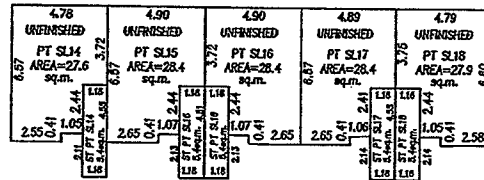

### BASEMENT FLOOR

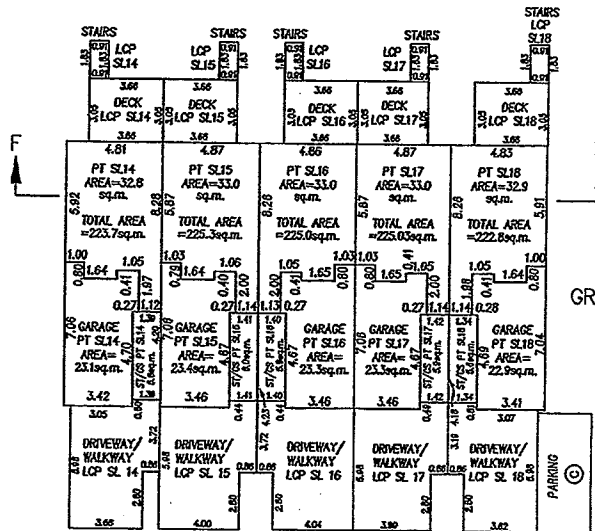

### GROUND FLOOR

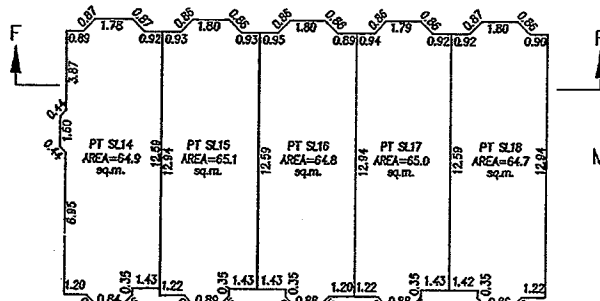

### MAIN FLOOR

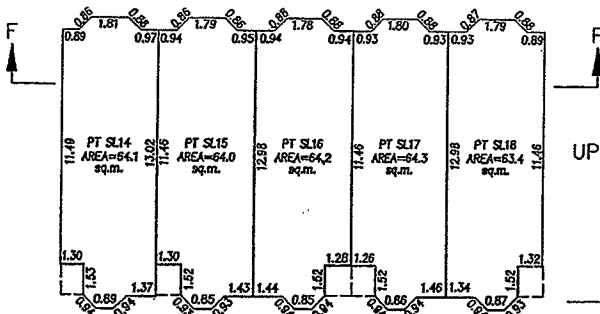

### UPPER FLOOR

G.A.R.

B.C.L.S.

DATED THIS 25<sup>th</sup> DAY OF SEPTEMBER 1994.

128°34'2

SHEET 13 OF 19 SHEETS

# FLOOR PLANS STRATA PLAN LMS 1660

SCALE 1: 200

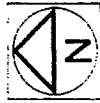
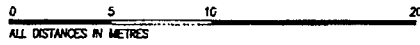

## BLOCK 6 GROUND FLOOR

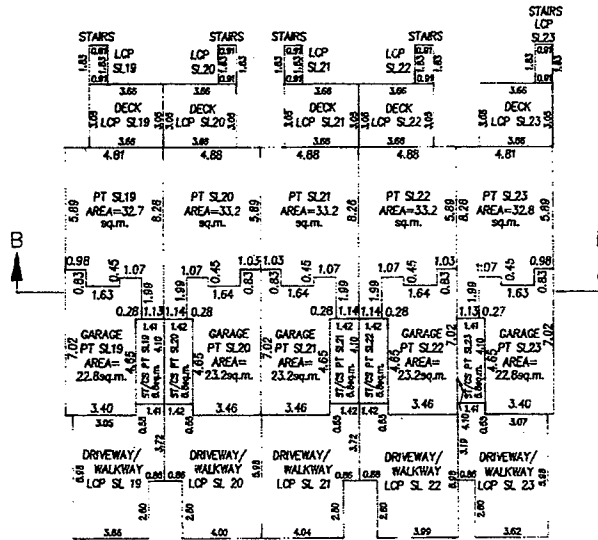

## MAIN FLOOR

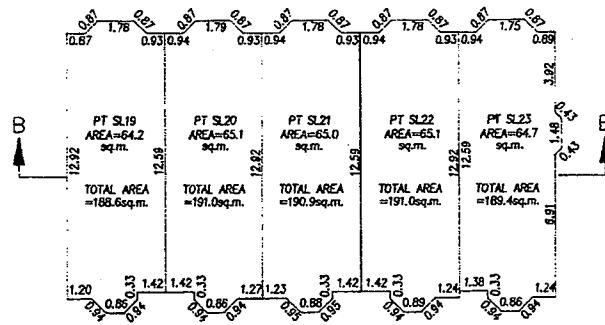

## UPPER FLOOR

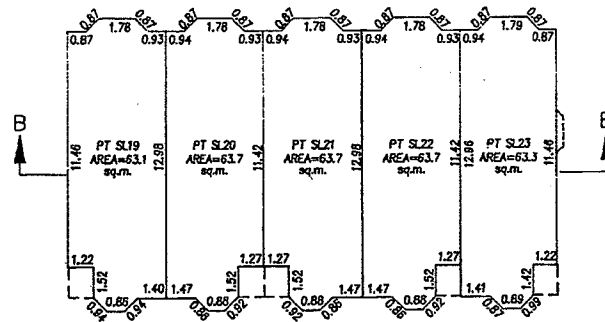

G.A.R.

B.C.L.S.

DATED THIS 26th DAY OF SEPTEMBER 1994.

# FLOOR PLANS STRATA PLAN LMS 1660

SCALE 1:250

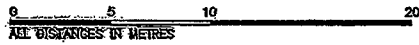

## BLOCK 7 GROUND FLOOR

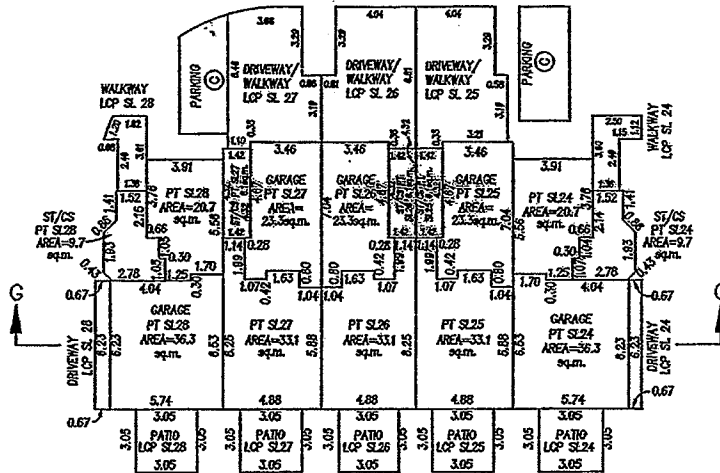

## MAIN FLOOR

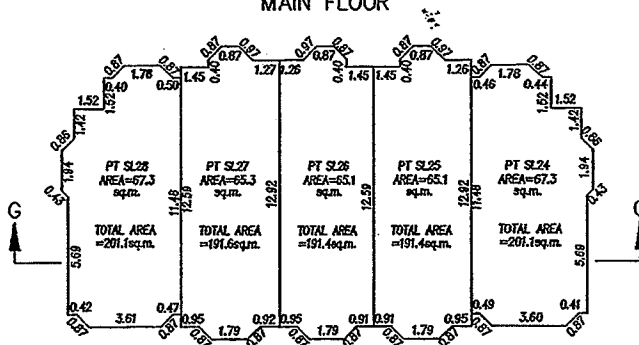

## UPPER FLOOR

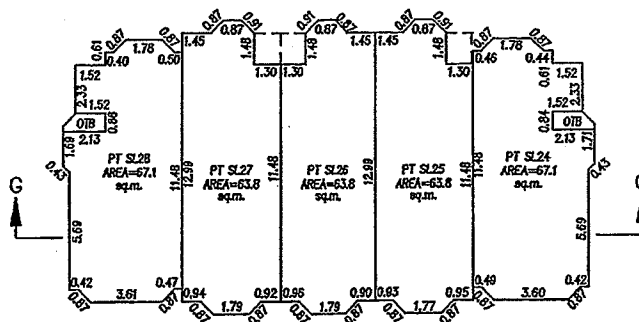

G.A.R.

B.C.L.S.

DATED THIS 28<sup>th</sup> DAY OF SEPT. 1984.

SECTIONS

STRATA PLAN LMS 1660

SCALE 1:200

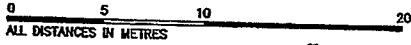

ALL DISTANCES IN METRES

SECTION A - A  
BLOCK 1

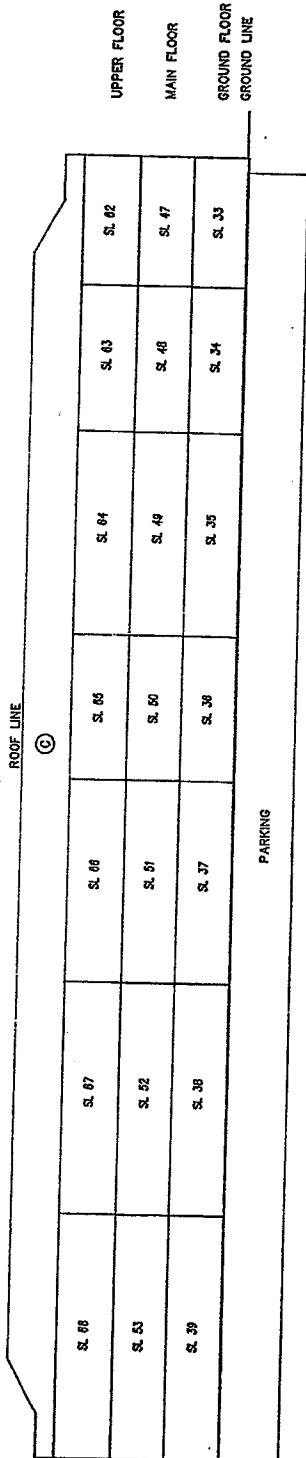

SECTION B - B  
BLOCK 1

BLOCK 6

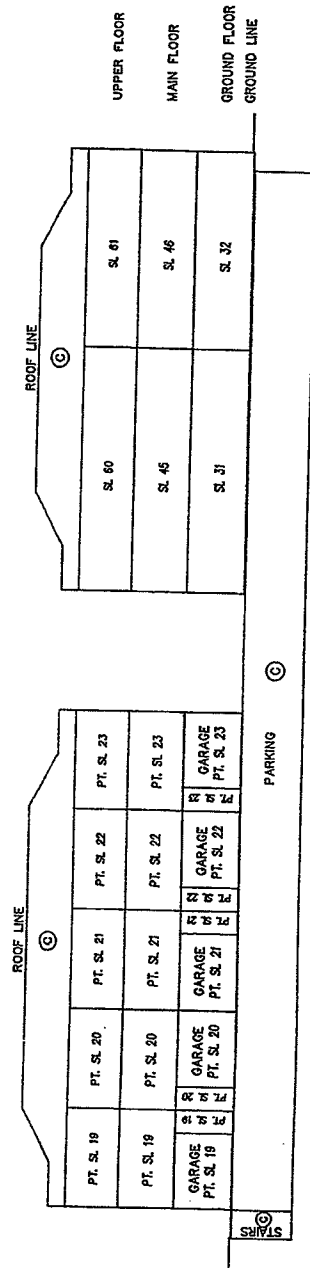

G.A.R.

DATED THIS 28<sup>th</sup> DAY OF SEPT. 1984. B.C.L.S.

COMPUTER 12897A15

SHEET 16 OF 15 SHEETS

SECTIONS

STRATA PLAN LMS 1660

SCALE 1:200

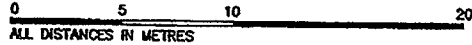

SECTION C - C  
BLOCK 2

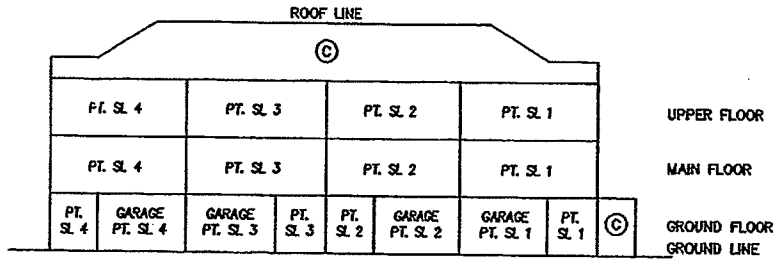

SECTION D - D  
BLOCK 3

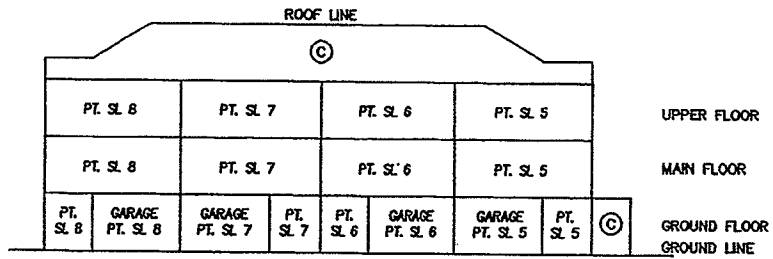

SECTION E - E  
BLOCK 4

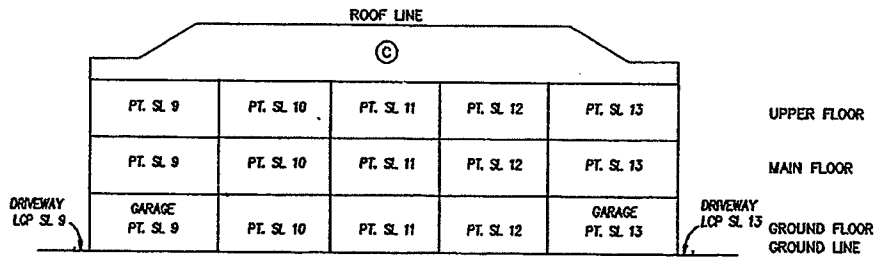

G.A.R.

B.C.L.S.

DATED THIS 28<sup>th</sup> DAY OF SEPT. 1994.



SECTIONS

STRATA PLAN LMS 11660

SCALE 1:200

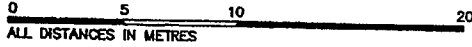

SECTION F - F  
BLOCK 5

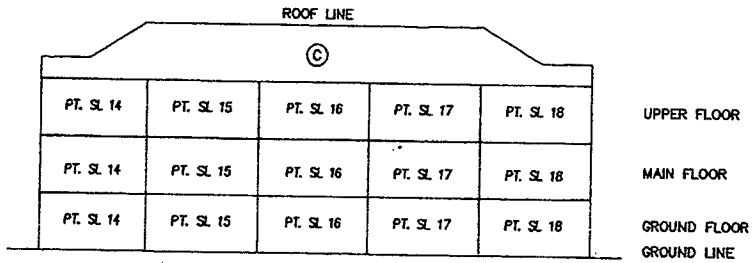

SECTION G - G  
BLOCK 7

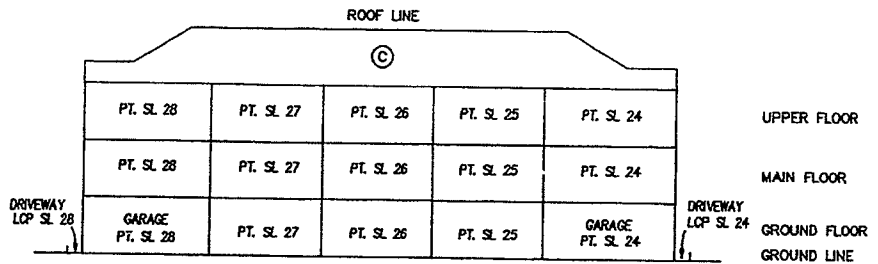

G.A.R.

B.C.L.S.

DATED THIS 28<sup>th</sup> DAY OF SEPT. 1994.

SHEET 16 OF 19 SHEETS

STRATA PLAN LMS 1660

RECORD OF BY LAWS AND ORDERS ETC.

FILING		DOCUMENT	
NUMBER	DATE	DATE	NATURE OF PARTICULARS
8038184	26-10-1994		FOAM & ANTIFOAMING AS CHEMICALS OF BYLAWS

G.A.R. REC'D  
DATED THIS 28<sup>TH</sup> DAY OF SEPT., 1994.

SHEET 18 OF 19 SHEETS

STRATA PLAN LMS 1660

DEALINGS AFFECTING THE COMMON PROPERTY

REGISTRATION		DOCUMENT	
NUMBER	DATE	DATE	NATURE OF PARTICULARS
7115	12-10-1982		THIS TITLE MAY BE INTERESTED BY A POWER GIVER
			DATE 89 OF THE HAWAIIAN ACT. SEE FOR R.E. E.O. SERVICES WITH
204522	07-05-1984		STATUTES ABOUT OF CITY
			DISTRICT OF SANDS
			ADON DISE
			18208 HIAH
06428271	03-11-1992		CONFIDENT
			DISTRICT OF SANDS
			1.1.7.8. SECTION 211
			AUTON RAIN

G.A.R. REC'D  
DATED THE 28<sup>TH</sup> DAY OF SEPT., 1994.